

PATH MARKER SPECIFICATION

Version 3: Last update 20/05/2025

Hudson
lighting

| | |
|------------------------------------|---|
| Power | 1.6W 2.6W 3.6W All at 350mA |
| Ingress protection rating | IP68 Still maintains full serviceability of all parts including the LED |
| Cable | 0.5mm CSA, 2m long, longer on request Suitable for use from -40C to +70C. Inner cores to +105C. Cable made in Worsley, UK |
| Colour Temperature (Kelvin) | 1800K (1.6W only) 2200K (1.6W only) 2700K 3000K (1.6W and 2.6W only) |
| Beam options | 60 degree opening. Others available on special request |
| TM66 | Overall: 2.6 - Excellent circularity |
| CRI | 80+ Standard, 90-97 available on request |
| Finishes | Black powder coat Nato green powder coat CorTen powder coat Bronze (RAL 8040) powder coat Custom RAL's available Solid Metals - Brass, Copper and Bronze |
| Warranty | 10 Years. Remanufacturing/Refurbishment available for 25 years beyond the date of manufacturing |
| Efficiency | 187 lm/W at chip |
| Input Power | 350mA wired in series - 42W maximum driver wattage (120VDC - maintaining Extra low voltage) |

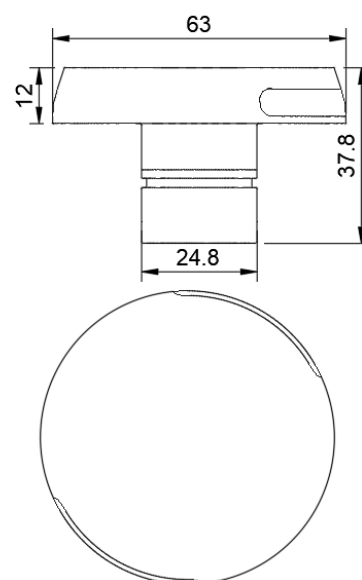

PATH MARKER SPECIFICATION

Hudson
lighting

| | |
|--|---|
| Replacement Components | LED board Cable with protection circuit Top Back 360 degree lens O-rings |
| Light Total length Light Diameter | 37.8mm 63mm diameter on the top, 24.8mm on the bottom/back |
| Packaging | Packaging is manufactured in Essex from 100% recycled content. The cardboard tubes can be continue to be recycled or returned to us for direct re use. The end caps are made from 100% recycled polypropylene and can again be re used or recycled. |
| Available Accessories | Mounting sleeve |

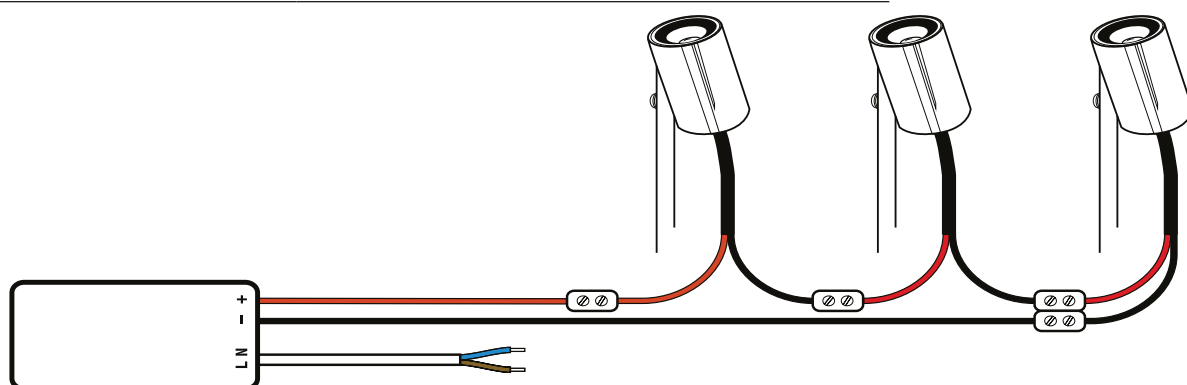

TYPICAL WIRING. NOTE SERIES CONNECTION - INTO POSITIVE, OUT OF NEGATIVE INTO POSITIVE ETC. Easy connection boards are available as an alternative.



COMPLIANCE

Hudson
lighting

For the purposes of UKC, Hudson Lighting Ltd, located at Unit 18 Redlands Centre, Redlands, Coulsdon, Surrey, CR5 2HT is responsible for compliance and documentation. Further details can be requested from info@hudsonlighting.co.uk

Declaration of conformity available on request.

**UK
CA**

Hudson Lighting Ltd (Ireland), registered at Unit 3D North Point House, North Point Business Park, Co. Cork, Ireland, is the responsible entity for ensuring compliance with all applicable European Union directives and regulations, including CE marking.

CE

As the designated European representative, Hudson Lighting Ltd (Ireland):

Ensures conformity of products with the relevant EU legislation.
Maintains the technical documentation required under CE marking.
Acts as the primary contact for European regulatory authorities.

Compliant with 2014/35/EU (Low Voltage Directive), 2014/30/EU (EMC Directive)

Meets Ecodesign Directive (2009/125/EC) and uses 100% recyclable packaging materials.

Conforms to 2001/95/EC.

Declaration of conformity available on request.

Environmental Compliance and Recycling

Hudson Lighting Ltd is fully compliant with the European Union's WEEE Directive (2012/19/EU), ensuring responsible recycling of waste electrical and electronic equipment. Our WEEE Producer Registration Number is WEE/MM3712AA, and we are a proud member of Recolight, supporting sustainable disposal and recycling initiatives.

For recycling and disposal information, visit: <https://www.recolight.co.uk/>

